

# Driving Parking Technology

## WPS-BC Easy Entry terminal

The machine readable BC Easy entry terminal is the controlling device at the entry to an off-street parking facility and processes daily tickets and subscriber cards. Thermal print-at-issue barcode technology provides a contactless ticket environment that ensures a highly reliable ticket read rate.

### Processing data

The entry terminal is equipped with a universal micro-processor board (MPB) to process the data generated from every type of transaction. A built-in battery back up retains transactions and clock functions.

### Processing daily parkers

Daily parking barcode tickets are printed by the thermal graphical printer and are dispensed by push button or automatic issue. It is also possible to process chip and / or credit cards as daily parkers.

### Processing subscribers

- The barcode insertion reader processes barcode subscriber cards. This reader is used as a standard throughout the BC Easy system.
- Proximity cards or tags are processed by a contactless reader which reads from a distance up to 100 mm (Short Range).
- Chip and / or credit cards (specified per country) are processed by one insertion reader.

### Communication, security and customer assistance

A two-way voice intercom station can be included in the terminal as well as a pinhole CCTV camera for security. This allows patrons to contact parking lot management when assistance is needed.



**wps**  
PARKING SYSTEMS

Imtech

[www.wps-group.com](http://www.wps-group.com)



# Driving Parking Technology

## Information

- The entry terminal comes equipped with a standard LCD display that has two lines of programmable text with 20 characters each.
- The fascia plate is made of lexan foil and clearly directs customers through transactions with text and symbols.

## Housing

The entry terminal housing (including service door with security lock at the rear) is manufactured from plated steel and is powder coated in RAL9007 grey to ensure an attractive, corrosion free appearance throughout its long life. A built in vibration sensor detects any vandalism attempts and immediately reports incidents to the management computer.

## Vehicle detection

The BC Easy entry terminal can be equipped with a vehicle detector which is used to arm the terminal for use only when a vehicle is present. Multi-loop directional logic can be incorporated.

## Temperature control

A thermostatically controlled heater regulates internal temperature.

## Mounting

The entry terminal can be mounted directly to the ground (or concrete island) or to a pre-fabricated foundation.

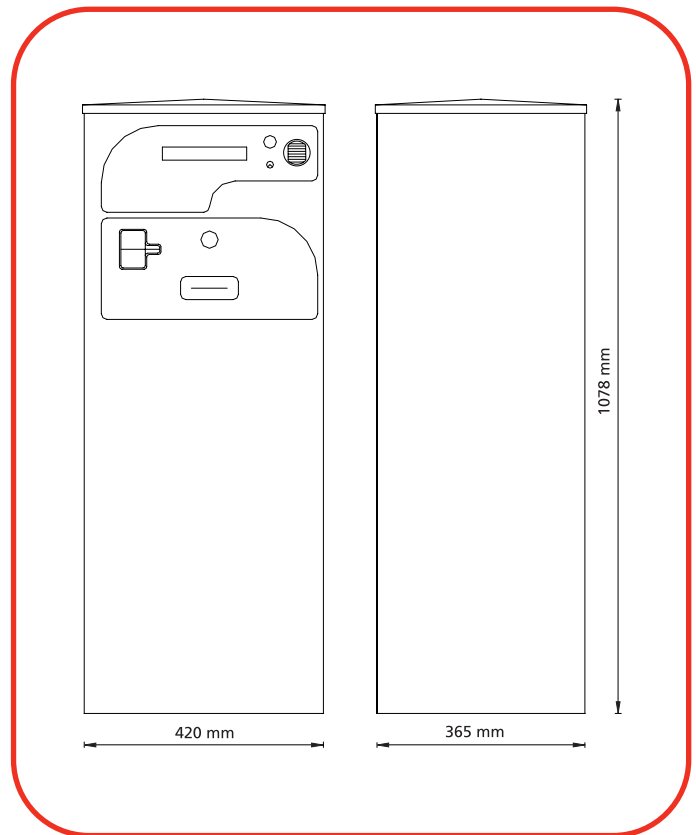

## Technical specifications:

Power supply	: 120 / 230VAC
Power consumption	: 100VA (without heater)
Heater	: 250 / 400VA
Open command	: 24V / 1A
Close command	: 24V / 1A
In / out of order	: 24V / 1A
Full / pre-full	: 24V / 1A



# Driving Parking Technology

## WPS-BC Easy Exit terminal

The machine readable BC Easy exit terminal is the controlling device at the exit of an off-street parking facility and processes daily tickets and subscriber cards.

### Processing data

The exit terminal is equipped with a universal microprocessor board (MPB) to process the data generated from every type of transaction. A built-in battery back up retains transactions and clock functions.

### Processing daily parkers and subscribers

- The barcode insertion reader processes barcode subscriber cards and is equipped with a swallower for daily tickets and discount coupons.
- Proximity cards or tags are processed by a contactless reader which reads from a distance up to 100 mm (Short Range).
- Chip and / or credit cards (specified per country) are processed by one insertion reader. A printer automatically issues receipts for credit card payments automatically or at request.

### Communication, security and customer assistance

A two-way voice intercom station can be included in the terminal as well as a pinhole CCTV camera for security. This allows patrons to contact parking lot management when assistance is needed.

### Information

- The exit terminal comes equipped with a standard LCD display that has two lines of programmable text with 20 characters each.
- The fascia plate is made out of lexan foil and clearly directs customers through transactions with text and symbols.



**wps**  
PARKING SYSTEMS

Imtech

[www.wps-group.com](http://www.wps-group.com)



# Driving Parking Technology

## Housing

The exit terminal housing (including service door with security lock at the rear) is manufactured from plated steel and is powder coated in RAL9007 grey to ensure an attractive, corrosion free appearance throughout its long life. A built in vibration sensor detects any vandalism attempts and immediately reports incidents to the management computer.

## Vehicle detection

The BC Easy exit terminal can be equipped with a vehicle detector which is used to arm the terminal for use only when a vehicle is present. Multi-loop directional logic can be incorporated.

## Temperature control

A thermostatically controlled heater regulates internal temperature.

## Mounting

The exit terminal can be mounted directly to the ground (or concrete island) or to a pre-fabricated foundation.

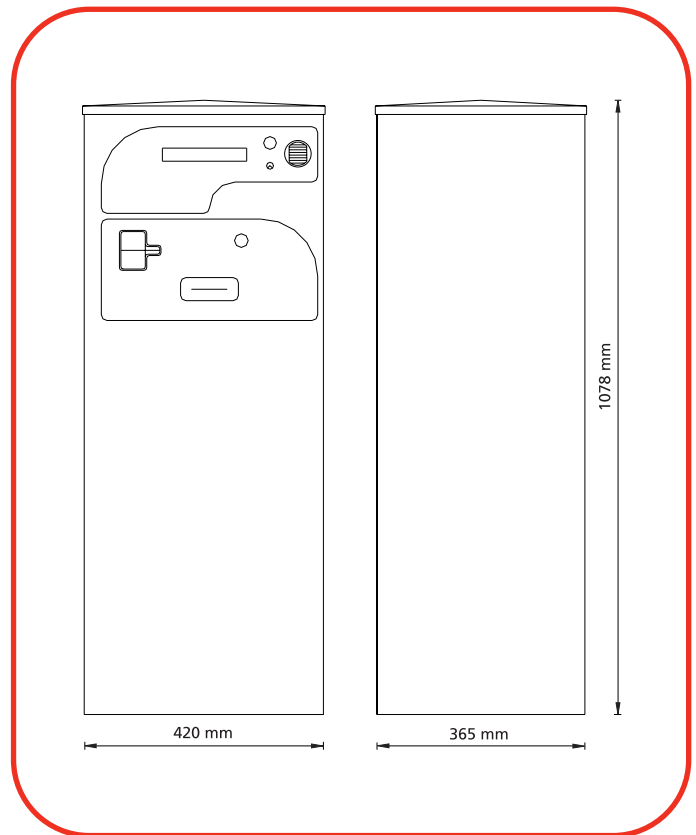

## Technical specifications:

Power supply	: 120 / 230VAC
Power consumption	: 100VA (without heater)
Heater	: 250 / 400VA
Open command	: 24V / 1A
Close command	: 24V / 1A
In / out of order	: 24V / 1A
Full / pre-full	: 24V / 1A



# Driving Parking Technology

## WPS-BC Easy Pay on foot station

The machine readable self serve pay on foot station is the automatic payment device located strategically around the parking facility to enable a parkers to pay the fee due before returning to their vehicle. The customer friendly terminal guides users step-by-step through the payment transaction. The pay on foot station interfaces with the BC Easy entry terminal and express exit terminal as part of a complete on-line revenue control system for your parking facility.

### Processing data

The pay on foot station is equipped with a microprocessor board (MPB) which is universal in all BC Easy terminals.

### Processing coins

The coin acceptance mechanism accepts up to eight different coin denominations and dispenses change in four. A receipt is issued on request. Four coin types are recycled into the coin dispensing tubes to replenish the number of coins available for change. When the change tubes are full, additional coins fall directly into the locked coin vault.

### Processing banknotes

The banknote reader accepts bills that are specified in the BC Easy software for each system. Valid notes are ingested by the reader and are placed in a self stacking vault. Receipts are issued upon request or automatically.

### Processing barcode tickets

A barcode insertion reader reads daily barcode tickets for fee calculation. Several types of barcode discount tickets can be used in conjunction with the daily ticket.

### Processing chip / credit cards (specified per country)

Chip and / or credit cards are processed by one insertion reader. Credit card processing is done through an interface to an approved clearing house or other credit card processing system. Receipts are issued upon request.



**wps**  
PARKING SYSTEMS

Imtech

[www.wps-group.com](http://www.wps-group.com)





# Driving Parking Technology

## WPS-BC Easy Manual pay station

The manual pay station is the system device used to process manual payment methods.

### Processing data / controller box

The central controller box houses a microprocessor board (MPB) which is universal in all BC Easy terminals.

### Desktop control panel / processing barcode tickets

The desktop control panel contains 6 pushbuttons for several functions and a barcode insertion reader for processing subscriber barcode cards and daily barcode tickets. Optionally the barcode insertion reader can be replaced by a proximity version.



### Processing chip / credit cards (specified per country)

One single reader (insertion) can be applied to process chip and / or credit cards (specified per country).

### Information

The manual pay station is equipped with a standard 2x20 lines LCD display to provide parking information.

### Printer

A printer issues the required shift reports and receipts.



# Driving Parking Technology

## Configuration exit cashiering

The manual pay station can be configured for exit cashiering. In this case, the following subscribers can also be processed:

- proximity cards or tags are processed by a contactless reader which reads from a distance up to 100 mm (Short Range).

## Cash drawer

The manual pay station can be equipped with a cash drawer.

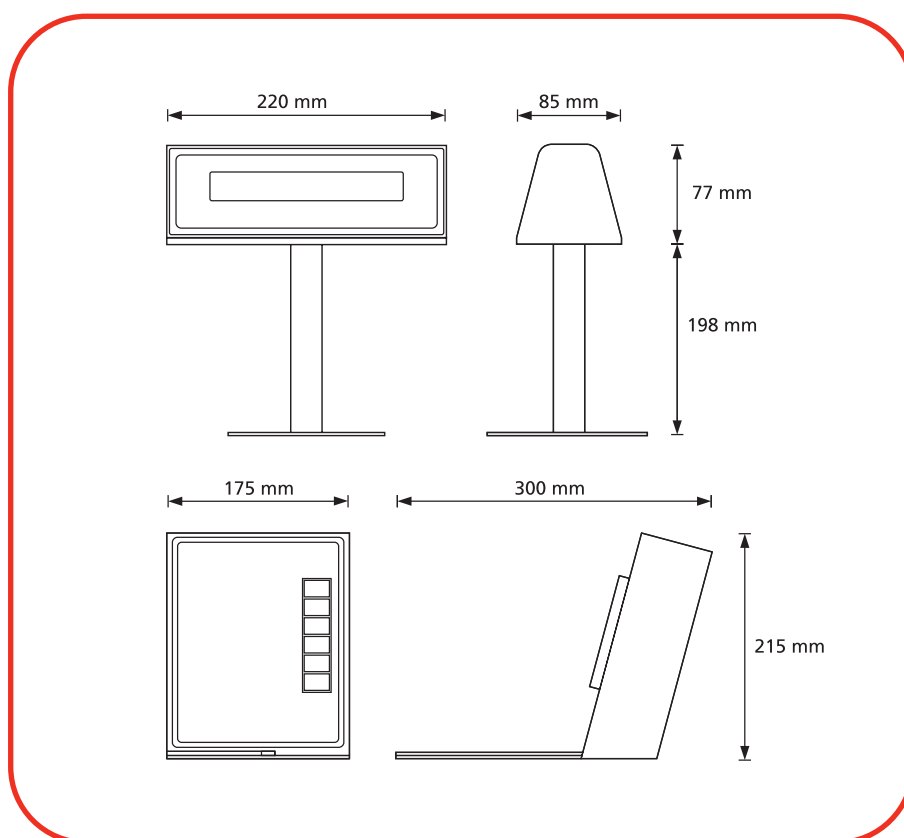

## Technical specifications:

Power supply	: 120 / 230VAC
Power consumption	: 100VA
Open command	: 24V / 1A
Close command	: 24V / 1A
Controller box	: 600x400x200 mm





# Driving Parking Technology

## WPS-BC Easy Central data registration system

The Central Data Registration System is the central control station through which the PC manages, controls and programs the wide range of functions available in the BC Easy parking control system.

### Processing data / controller box

The central controller box houses the universal micro processor board (MPB) that processes the data gathered from all the system nodes.

### WPS BC Easy software

The modular BC Easy software communicates with all system devices to provide accurate, real-time information. By selecting the appropriate software modules, the system can be tailored to meet the operational requirements of each site. Typical software modules include:

- control panel: *monitor transactions and system functionality*
- processing of daily parkers: *revenue control*
- processing of subscribers: *access control groups and time zones*
- print menu: *generate access control cards and discount coupons*
- alarms: *monitor system alarms*
- statistics: *review transaction information*
- discounts: *provide various discount types*
- counters: *monitor parking space availability for the entire system and by level / lot*
- multiple rate structures: *flexible fee management*



**wps**  
PARKING SYSTEMS

Imtech

[www.wps-group.com](http://www.wps-group.com)



# Driving Parking Technology

## Management unit

A proximity card reader or a credit card reader can be connected to the PC to enable the programming of proximity or credit cards into the system. A standard laser printer is used to produce management, audit and statistical reports. It is also used for the production of customized pass cards, and free exit or discount coupons.

## Technical specifications:

Power supply	: 120 / 230VAC
Power consumption	: 100VA
Full/free	: 24V / 1A
Controller box	: 600x400x200 mm

